



Tutorial 3



Obtain the Sample files required from the College 'Q' Drive Mechanical Engineering section
(Ensure you copy the files off the Q drive to your own computer)

The Sample files can also be downloaded on some computers directly from the tutorial page

Instructions:

With reference to the dwfx model of the Prosthetic Leg General Assembly

- Part A: Create an assembly model of the top part of the Prosthetic leg. Use the Calf produced in Tutorial 2. Ensure the the Calf Knee joint Top is horizontal and Straight as shown in the dwfx example.

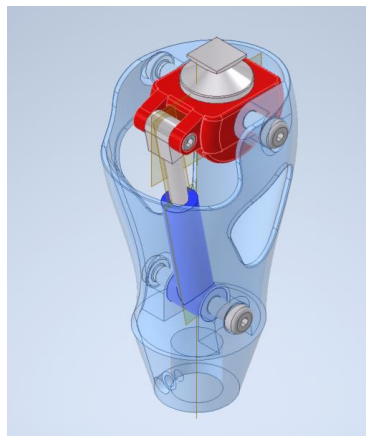

Save as Prosthetic Leg Top. iam

- Part B: Create another separate assembly model of the bottom half of the Prosthetic leg.
- Apply a 1mm ISO fillet weld to join the Foot Boss centrally on the Foot Support Bracket..

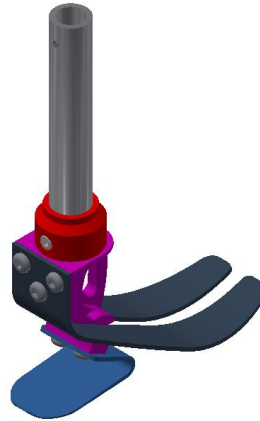

Save as Prosthetic Leg Bottom.iam

- Create another assembly to create a General assembly model of the entire leg using the assemblies created in part A and part B of this tutorial. Insert a ISO 4762 M6 fitting to join the 2 subassemblies.



- Save the completed Sub assembly (iam) models and the General assembly (iam) model for later use in the Assignments.

(Be careful with the file management).

- Save the General assembly model as Tutorial 3.dwfx for handing in.